



OBERDORFER[®]

An Ingersoll Rand Business

107M

Bronze Close Coupled Centrifugal Seawater Pumps



OB107MA-F25

Features

- Pipe Size: Inlet 1-1/4", Outlet 1"
- A Standard in the marine air conditioning industry
- Rugged Cast Bronze Construction
- Precision machined and balanced impeller for extremely quiet operation
- Reliable - minimal maintenance needed
- Discharge port orientation flexibility
- Shaft Seal: Unitized Type 16 Buna Mechanical Carbon-Ceramic faces
- Motor Configuration:
 - 1/3 HP 50/60 Hz Single-phase
 - Cap Start TEFC Enclosure
 - 303 Stainless shaft
 - Thermal overload protection
 - Factory wired high voltage
 - 7' Long 18/3 SJO Power Cord with leads
- Drop in replacement for models 67, 67-3, P120Z, and P700Z

Drive

These single stage end suction close-coupled pumps use standard NEMA C-Flange 56J Pump Motors with rigid base and threaded shaft end to accept the pump impeller.

These centrifugal pumps are not self-priming. They must be installed below the liquid level so that the liquid flows to the pump by gravity (flooded suction). However, if a foot valve is used at the beginning of the suction line, and all air is bled from the pump by manual priming, the pump will lift on the suction side up to 15 feet.

Performance

CAPACITY, WATER 70°F

MODELS 107MA-F25 (3.0 IMP), 107MB-F25 (3.44 IMP)

Pump will lift on the suction side up to 15 feet

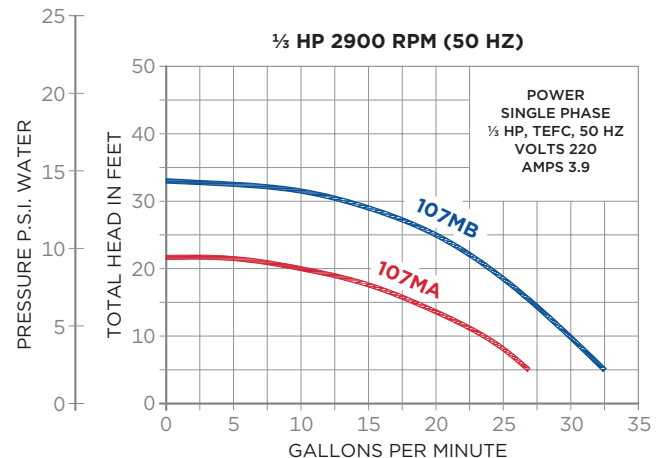
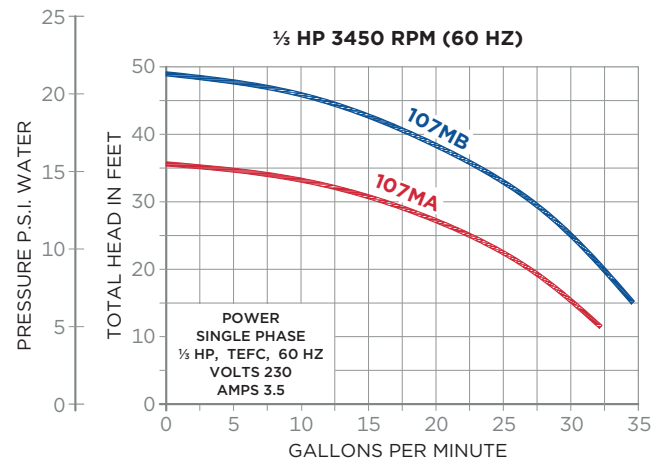

Such a system relies entirely on the non-leaking foot valve for starting capability. The flow of a centrifugal pump can be conveniently controlled by a throttling valve in the discharge line without the need for a relief valve. In centrifugal pumps, the horsepower demand will decrease as the pressure increases. Maximum horsepower occurs with a wide open discharge.



OBERDORFER®

An Ingersoll Rand Business

Liquids and Temperature

The alloy used provides superior corrosion resistance to sea water. The pumps are equally suitable for nonpotable fresh water, and aqueous solutions compatible with buna rubber and bronze. Questions as to the chemical compatibility of special liquids should be referred to the factory. Liquids contaminated with small solids or abrasives can be handled, but a reduction in mechanical seal life must be expected.

Dimensions

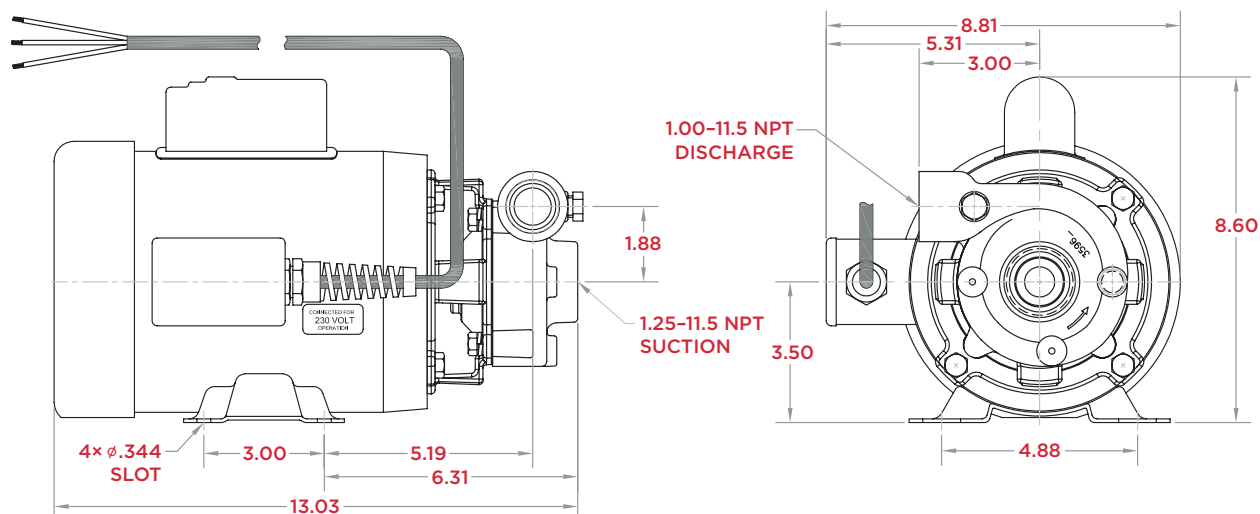

Exploded View and Parts List

| ITEM NO. | DESCRIPTION | MODEL NO. | | QTY. |
|----------|------------------------------|-------------|-------------|------|
| | | OB107MA-F25 | OB107MB-F25 | |
| 1 | Body | OB3576 | OB3576-1 | 1 |
| 2 | Adapter | OB3574 | OB3574 | 1 |
| 3 | Impeller | OB35751 | OB3575 | 1 |
| 4 | O-Ring | OB8232 | OB8232 | 1 |
| 5 | Seal Assembly | OB32008 | OB32008 | 1 |
| 6 | Screw | OB7637 | OB7637 | 4 |
| 7 | Lockwasher | OB3736 | OB3736 | 4 |
| 8 | Screw | OB7636 | OB7636 | 4 |
| 9 | Plug | OB3616-1 | OB3616-1 | 1 |
| 10 | Motor | OB3595 | OB3595 | 1 |
| 11 | Label | OB2904 | OB2904 | 1 |
| 12 | Power Cord | OB3593-1 | OB3593-1 | 1 |
| 13 | Strain Relief Flex Cord Grip | OB3592 | OB3592 | 1 |
| 14* | Tie Wrap | OB3318 | OB3318 | 1 |
| 15* | Ring Terminal | OB3594 | OB3594 | 1 |
| 16 | Pipe Plug | n/a | OB7043 | 1 |

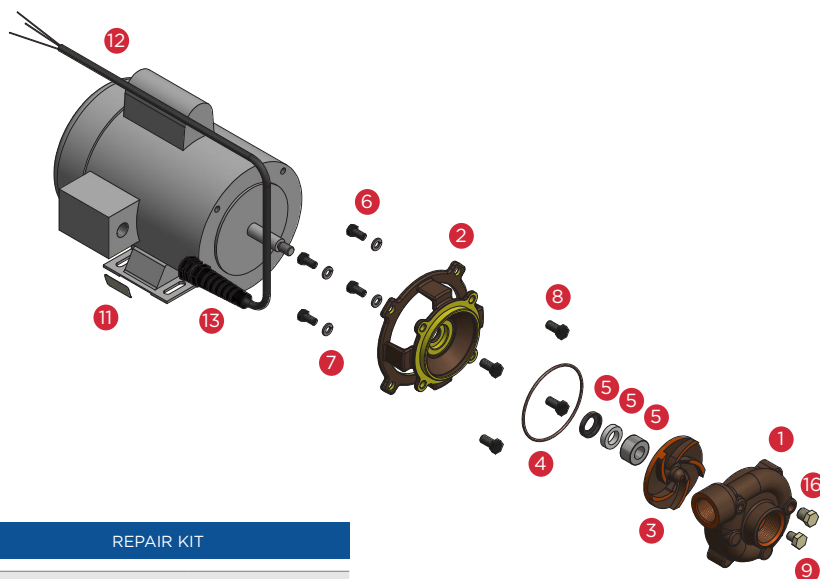

| REPAIR KIT | |
|----------------|---------|
| OB107MA-F25 | OB12451 |
| OB107MB-F25 | |
| Items Included | 3, 4, 5 |

* Items 14 & 15 are not depicted in the exploded assembly

IR Ingersoll Rand

12500 South Pulaski Road
Alsip, IL 60803, USA
Phone (800) 448.1668